

Pendant Mount Link Kit

Installation Instructions for Linear Strip Fixture

For 2' 4' and 8' Linear Strip Fixture (SFAM10)

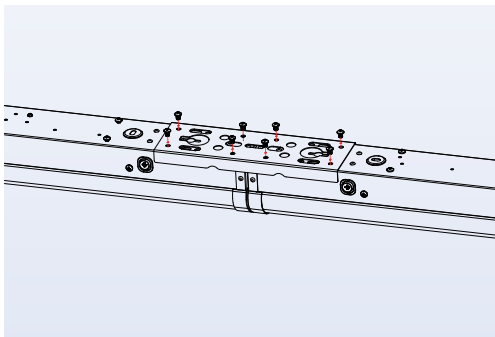

WHAT COMES IN THE SFAM10 KIT PACKAGE

Linear Strip Fixture Pendant Mount Link Kit comes with the following standard parts:

Pendant Mount Link Kit Screws (x8)

*Before installation, carefully remove all parts from the packaging.
Inspect product for defects due to shipping.*

Before starting installation, turn off power at circuit breaker.

1. For every two fixtures connected, one Pendant Mount Link Kit and eight screws are required. (Figure 1)

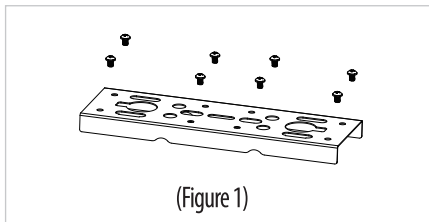

(Figure 1)

2. Secure the link kit to the first fixture using 4 screws. (Figure 2)

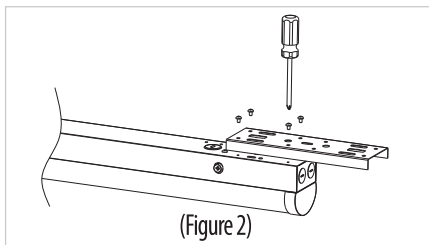

(Figure 2)

3. Align the second fixture with the link kit, then fasten the remaining 4 screws. (Figure 3)

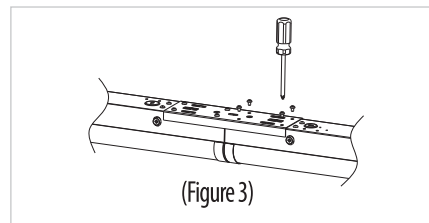

(Figure 3)

4. After tightening the screws, the installation is complete. (Figure 4)

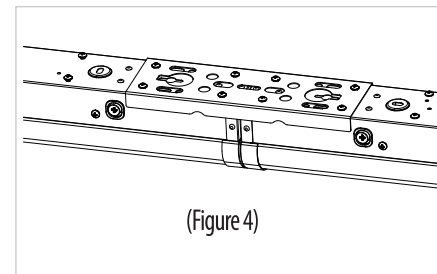

(Figure 4)

Thank you for choosing

LITETRONICS®

6969 W. 73rd Street

Bedford Park, IL 60638

WWW.LITETRONICS.COM

CustomerService@Litetronics.com or 1-800-860-3392



The information and product specifications contained in these instructions are based upon data believed to be accurate at the time of printing. This information is subject to change without notice and without incurring liability. If you have questions regarding specific product details, please contact us at 800-860-3392 or via email at customerservice@litetronics.com. To check for an updated version of these instructions, please visit www.litetronics.com.

REV: 5/15/26