

LED ROUND DOWNLIGHT

WATT AND CCT SELECTABLE WITH SENSOR CAPABILITY

PROJECT:	
CATALOG #	
TYPE:	DATE:

DESCRIPTION

Flexible, smart, and built for business. Upgrade your lighting solutions with the Litetronics LED Round Downlights, engineered for versatility, efficiency, and smart integration. Designed for commercial, retail, hospitality, and institutional environments, this fixture delivers superior performance while offering advanced customization options to meet diverse project needs.

One fixture, multiple configurations. Choose from a range of sizes, selectable wattage options, and selectable CCT settings—giving you complete control to tailor the ideal lighting solution for any space.

Future-proof your installations. These downlights are sensor-capable, enabling seamless integration with our Bluetooth control module (BCM02) and PIR sensor (SC014) for occupancy, daylight harvesting, and switches (BCS03 & BCS05), all sold separately.

Achieve 100–133 lm/W luminous efficacy for bright, uniform illumination while reducing energy costs. Rated for wet locations ensuring durability and reliability, backed by a 5-year warranty.

MOUNTING

- Recessed
- Grid ceiling

APPLICATIONS

- Offices
- Schools
- Restrooms
- Corridor
- Retail
- Commercial
- Healthcare
- Municipalities & Government
- Architecturally Enhanced Spaces

DIMENSIONS / WEIGHT

Order Code	Size	Diameter 1	Diameter 2	Height	Weight
DLR12W4S	4"	5.98"	4.43"	3.76"	0.99 Lb.
DLR15W6S	6"	8.41"	5.76"	4.24"	1.32 Lb.
DLR23W6S	6"	8.41"	5.76"	4.24"	1.32 Lb.
DLR28W8S	8"	10.04"	7.14"	4.56"	1.66 Lb.

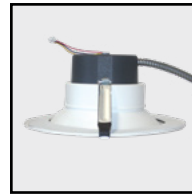
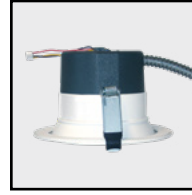
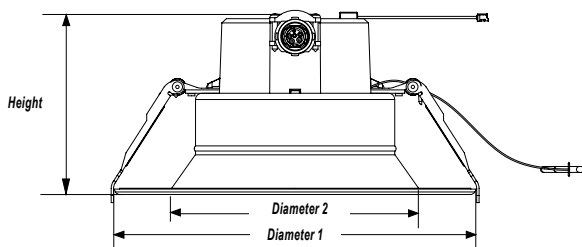

FEATURES

- 120-277V
- Energy Star rated
- Selectable Watt & CCT
- 26" Flexible conduit with knockout quick connector
- Safety Cable
- Optional Bluetooth Control Module (BCM02 sold separately)
- Optional PIR Sensor (SC014 sold separately)
- Tri-Mode Dimming: 0-10V (120-277V), TRIAC & ELV (120V only)
- 50,000-hour rated life
- 5-year warranty
- Wet location rating
- Local control via Bluetooth wall switch accessories (sold separately)
- TAA Compliant
- LiteSmart App compatible (requires BCM02)
- Compatible with Emergency Battery Backup (6" and 8" models only)

CERTIFICATIONS



SPECIFICATIONS

Life (@L70): 50,000 hours

Warranty: 5 years

PERFORMANCE

Operating temp: -4°F to 104°F (-20°C to 40°C)

Efficacy (LPW): 100-133*

* LPW covers all wattages.

CRI: 90

ELECTRICAL

Input voltage: 120-277V

Input frequency: 50/60Hz

PF: ≥0.9

THD: ≤25%

Surge protection: 2.5KV

Dimming: 10-100%

Whip/Cord: 26' Flexible conduit with knockout quick connector

Sensor: Optional PIR Sensor Kit, Bluetooth Control Module

OPTICAL

Beam Angle: 90°

Lens: Polycarbonate

UGR: N/A

PHYSICAL

Finish: Spray coating

Color: White

Housing: Die-Cast Aluminum

INDUSTRY STANDARDS/RATINGS

IP: 54 (Front)

IK: N/A

Location: Wet

IC: Yes

ETL: Yes

FCC: Yes

RoHS: Yes

DLC: N/A

Energy Star: Yes

TAA: Compliant

PRODUCT OVERVIEW AND INSTALLATION

New Construction Installation

Create ceiling opening, using the provided hole template to ensure that the edge of the downlight will cover the entire opening and still sit firmly in the ceiling.

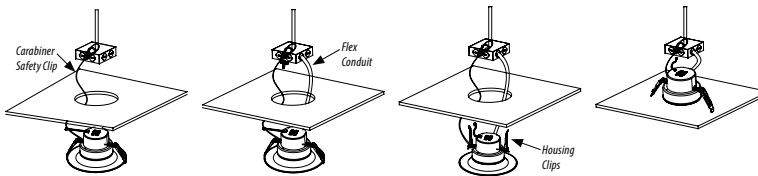

Retrofit Installation

Remove existing trim, can and CFL or incandescent bulb, and install.

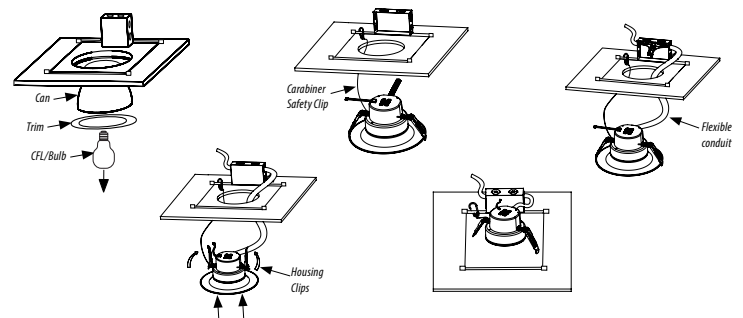

ORDERING INFORMATION



Main Fixture

Ordering Code	Description	Watts	Volts	CCT (K)	Lumens
DLR12W4S	12W 4" LED Round Downlight Watt and CCT Selectable with Sensor Capability	5 7 12	120-277V	2700 3000 3500 4000 5000	600 800 1200
DLR15W6S	15W 6" LED Round Downlight Watt and CCT Selectable with Sensor Capability	6 10 15	120-277V	2700 3000 3500 4000 5000	800 1100 1500
DLR23W6S	23W 6" LED Round Downlight Watt and CCT Selectable with Sensor Capability	13 17 23	120-277V	2700 3000 3500 4000 5000	1500 2000 2500
DLR28W8S	28W 8" LED Round Downlight Watt and CCT Selectable with Sensor Capability	12 22 28	120-277V	2700 3000 3500 4000 5000	1500 2500 3000



Disclaimer: Specifications are subject to change without notice. While Litetronics makes every effort to ensure accuracy, we do not guarantee the completeness or reliability of the information provided. For the most current product data, please visit www.litetronics.com.

ACCESSORIES

Accessories - Sensors & Controls





Ordering Code	Image	Description	Usage
SC014		PIR Sensor Kit for Downlights	Provides PIR occupancy sensing and daylight harvesting. Connects directly to the BCM02 (sold separately) using connection cable. BCM02 is required for wireless control of fixture, groups of fixtures through the LiteSmart app.
BCM02		Bluetooth Control Module for Downlights	Enables wireless control of fixtures, or groups of fixtures through the LiteSmart app. Connects to the fixtures driver (12V AUX and 0-10V DIM). SC014 (sold separately) is required installed at minimum on one fixture for motion sensing and daylight harvesting.

Accessories - Bluetooth Control Switches

Ordering Code	Image	Description	Usage
BCS03		Bluetooth battery powered wall switch	Control functionality of the fixture; on/off, dimming, daylight harvesting and scene selection with battery power.
BCS05		Bluetooth AC Powered Wall Switch 120-277V	Control functionality of the fixture; on/off, dimming and scene selection with AC power.



Note: Switches don't have CCT or wattage selectable capability.

Accessories - Emergency Battery Backup

Ordering Code	Image	Description	Usage
EB10*		10W Emergency Battery Backup	Supplies battery backup to an individual fixture for up to 90 minutes. Must be ordered with EBCM or EBAM indicator module. Field installed. <ul style="list-style-type: none"> Compatible with 6" (DLR15W6S, DLR23W6S) and 8" (DLR28W8S) downlights only.
EBCM		Ceiling-mounted Indicator Module	This Ceiling-mounted Indicator Module (EBCM) can be used with Litetronics' emergency battery backup product EB10 to provide a visual confirmation of the operational status of the EBB unit. This module is typically used in grid ceiling applications where it is recess mounted in a panel adjacent to the fixture.
EBAM		Adhesive-mounted Indicator Module	This Adhesive-mounted Indicator Module (EBAM) must be used with Litetronics' emergency battery backup product EB10 to provide a visual confirmation of the operational status of the EBB unit. This module is typically used in open ceiling or drywall ceiling applications where the module is applied to the side of the fixture, mounting kit, or a nearby structural element.
TR01		Test Remote Control	Used for testing and demonstrating the functionality of EB10 emergency battery backup integrated products. <ul style="list-style-type: none"> Only one remote required per area, building or site as necessary.

* **Note:** Compatible with 6" (DLR15W6S, DLR23W6S) and 8" (DLR28W8S) fixtures only.

Accessories - Mounts

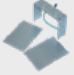
Ordering Code	Image	Description	Usage
DLRACP		LED Round Downlight Construction Plate Universal Size	For new construction applications, use mounting plates designed to align with joist spacing and ceiling grid systems (including T-bar). For remodel applications, plate can fully cover an existing opening or allow for proper enlargement to fit the intended LED downlights.
DLRAHB		LED Round Downlight Hanger Bar Universal Size	Universal hanger bars provide adjustable support for recessed downlights by spanning between frames and securing the construction plate or housing in the desired ceiling location.
DLRAJB		LED Round Downlight 3 Pc. Junction Box	The junction box accessory comes in three parts (one J-Box cage and two J-Box side covers). Mounts to the top side of the construction plate.





Accessories - Goof Rings

DLRAGR6		6" LED Downlight Round Goof Ring	Decorative trim rings used around recessed LED downlights to cover oversized holes, rough drywall cuts, or gaps in the ceiling, creating a clean, finished look.
DLRAGR8		8" LED Downlight Round Goof Ring	

Disclaimer: Specifications are subject to change without notice. While Litetronics makes every effort to ensure accuracy, we do not guarantee the completeness or reliability of the information provided. For the most current product data, please visit www.litetronics.com.

ACCESSORIES

Accessories - Trims

DLRATR4MB		4" LED Downlight Round Trim Ring Matte Black	Matte black, non-reflective trim for LED round downlights. Designed to reduce glare and complement modern interiors in residential and commercial spaces.
DLRATR6MB		6" LED Downlight Round Trim Ring Matte Black	
DLRATR8MB		8" LED Down Light Round Trim Ring Matte Black	
DLRATR4BR*		4" LED Downlight Round Trim Ring Bronze	Bronze, reflective trim for LED round downlights. Designed to complement modern interiors in residential and commercial spaces.
DLRATR6BR*		6" LED Downlight Round Trim Ring Bronze	
DLRATR8BR*		8" LED Downlight Round Trim Ring Bronze	
DLRATR4SV*		4" LED Downlight Round Trim Ring Matte Silver	Silver, reflective trim for LED round downlights. Designed to complement modern interiors in residential and commercial spaces.
DLRATR6SV*		6" LED Downlight Round Trim Ring Matte Silver	
DLRATR8SV*		8" LED Downlight Round Trim Ring Matte Silver	
DLRATR4BN*		4" LED Downlight Round Trim Ring Brushed Nickel	Brushed nickel, non-reflective trim for LED round downlights. Designed to complement modern interiors in residential and commercial spaces.
DLRATR6BN*		6" LED Downlight Round Trim Ring Brushed Nickel	
DLRATR8BN*		8" LED Downlight Round Trim Ring Brushed Nickel	

* **Note:** Made to order only.

Disclaimer: Specifications are subject to change without notice. While Litetronics makes every effort to ensure accuracy, we do not guarantee the completeness or reliability of the information provided. For the most current product data, please visit www.litetronics.com.