



LED HIGH BAY

FLEXIBILITY MEETS AFFORDABILITY



MADE IN USA AVAILABLE

LITETRONICS®

INNOVATION. SIMPLIFIED.

LITETRONICS®

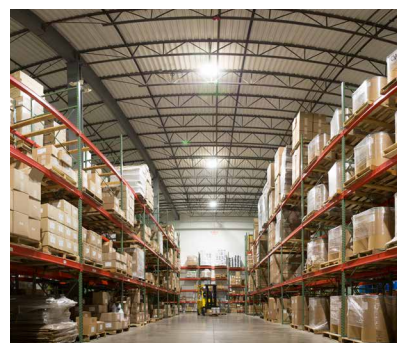

LED HIGH BAY

THE MOST FEATURES – AT AN OUTSTANDING PRICE

At just 18 pounds and under 6-inches tall, our lightweight, compact LED High Bays are the easiest way to install more efficient high bay ceiling lighting and increase overall energy savings. They use just half the energy of metal halide fixtures and two-thirds of the energy of T5 fluorescents. You'll also experience dramatically better light quality and color in a sleek, contemporary fixture that enhances any environment.

And unlike other LED high bay packages on the market, our offering combines a higher lumen/watt ratio, multi-yoke setting for application flexibility and includes IP-66 waterproofing as standard. In fact, our High Bay is priced competitively with products that have far fewer features. **And Litetronics backs its High Bays with a 10-year warranty for years of hassle-free performance.**





EXCEPTIONAL EFFICIENCY

**UP TO 131
LUMENS/WATTS**



FOOD SERVICE QUALIFIED

**APPROVED TO
NSF STANDARDS**



IP66 - RATED PRODUCTS

**WORK IN SNOW,
RAIN, SUN**



LED HIGH BAY REPLACES COMMON ALTERNATIVES

HIGHBAY WATTS	HIGHBAY LUMENS	REPLACE METAL HALIDE	REPLACE FLUORESCENT	MOUNTING HEIGHT
125	16000	250W	4 LAMP T5 and 6 LAMP T8	16' to 24'
185	24000	400W	6 LAMP T5 HO and 8 LAMP T8	20' to 24'
220	29000	750W	8 LAMP T5 HO	24' to 40'



SIMPLE, EASY INSTALLATION

- Easy to handle — just 16 lb, 6" tall
- Circular design aligns with pre-existing HID mounting layouts to maintain original aesthetics
- Multi-setting yoke for application flexibility

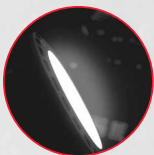

LONG-LASTING, HIGH-QUALITY LIGHT

- Half the energy of metal halides; two-thirds of T5 fluorescents
- Higher lumen/watt ratio than other LED high bays



RATED IP66—WATERPROOF

- Ideal for pools and outdoor applications
- Easy spray rinse cleaning
- Optional corrosion-resist coating for harsh chemical environments



RUGGED BUT SLEEK

- Contemporary look and feel
- Tough aluminum cast housing
- Shatterproof lens glass



ENERGY-SAVING FEATURES

- Integrated 0-10 low-voltage dimming
- Easy-mount motion sensors



HIGH BAY OUTPERFORMS METAL HALIDE

TRADITIONAL METAL HALIDE



Light depreciation 70% over 10,000 hours

Toned, off-color light; 65 Color Rated Index

No Dimming

1-5 minute warm up

Separate screen protection for bulb

LITE TRONICS® LED HIGH BAYS



Sustained, even light for 100,000 hours

High 84 Color Rated Index

Full dimming and proximity sensing

Instant on/off

Durable shatter-proof polycarbonate lens option

FOOT CANDLES BY HEIGHT

MOUNTING HEIGHT (FT)	DIAMETER (FT)	125W FOOTCANDLES AT NADIR	185W FOOTCANDLES AT NADIR	220W FOOTCANDLES AT NADIR
16	20.6	21.1	30.7	35.5
20	25.7	13.5	19.6	22.7
24	30.8	9.4	13.6	15.8
28	36.0	6.9	10.0	11.6
32	41.1	5.3	7.7	8.9
36	46.3	4.2	6.0	7.0
40	51.4	3.4	4.9	5.7

HIGH BAY LIFE

AMBIENT TEMP IN °C	AMBIENT TEMP IN °F	125W HOURS L70	185W HOURS L70	220W HOURS L70
25	77	106,500	106,500	106,500
30	86	106,500	106,500	106,500
35	95	106,500	106,500	106,500
40	104	104,500	104,500	103,000
45	113	105,000	105,000	100,500
50	122	104,500	104,500	98,000
55	131	104,000	102,000	94,000

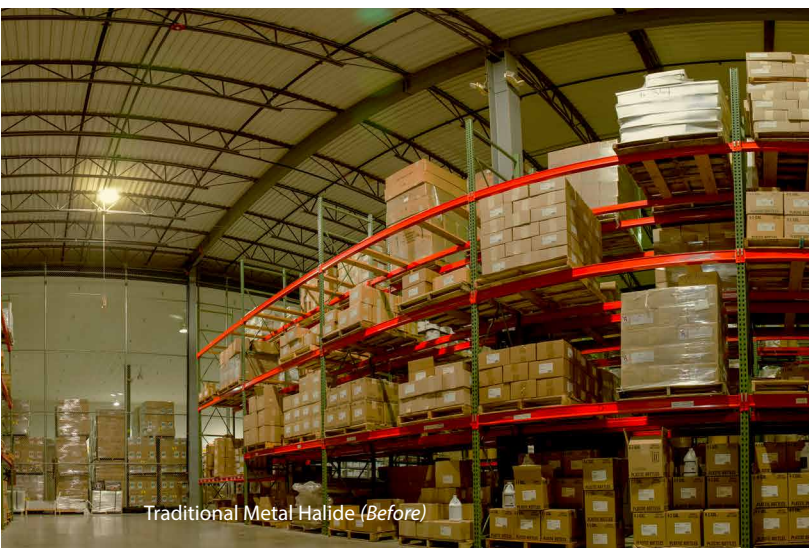

Traditional Metal Halide (Before)

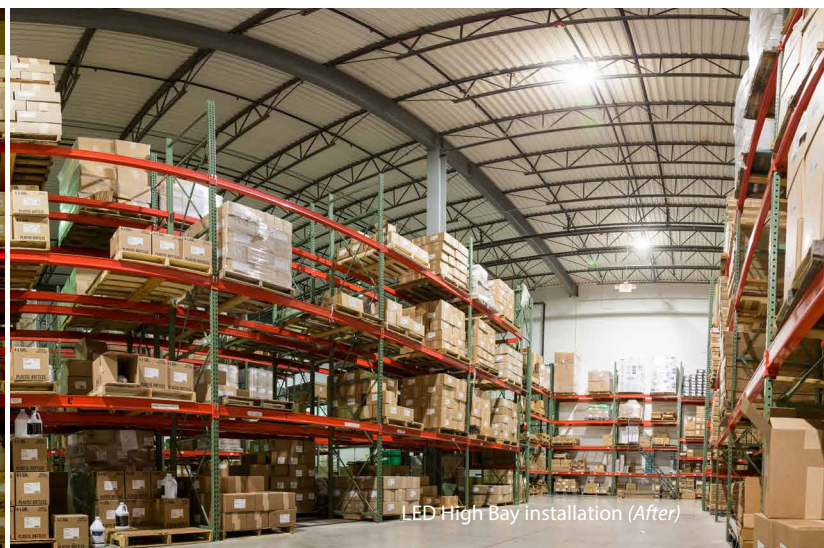

LED High Bay installation (After)

LED HIGH BAY ACCESSORIES

Flexibility for a range of applications

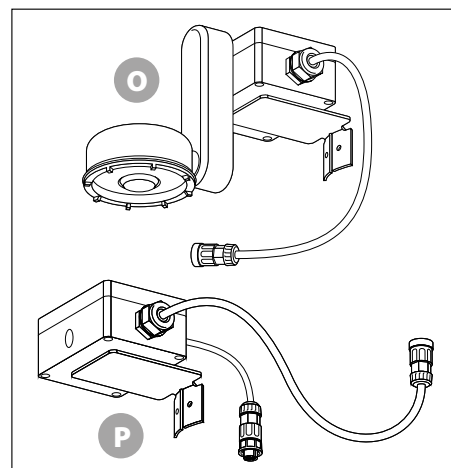
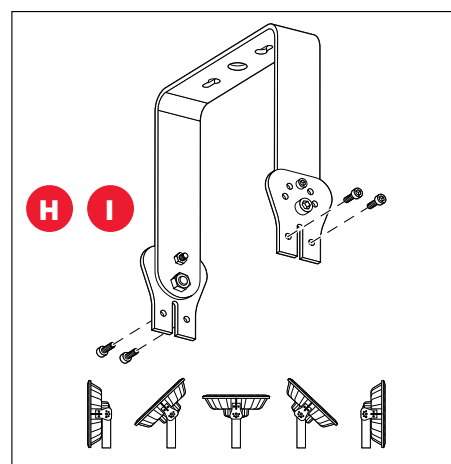
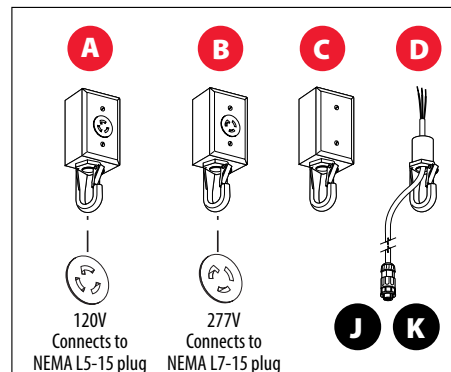
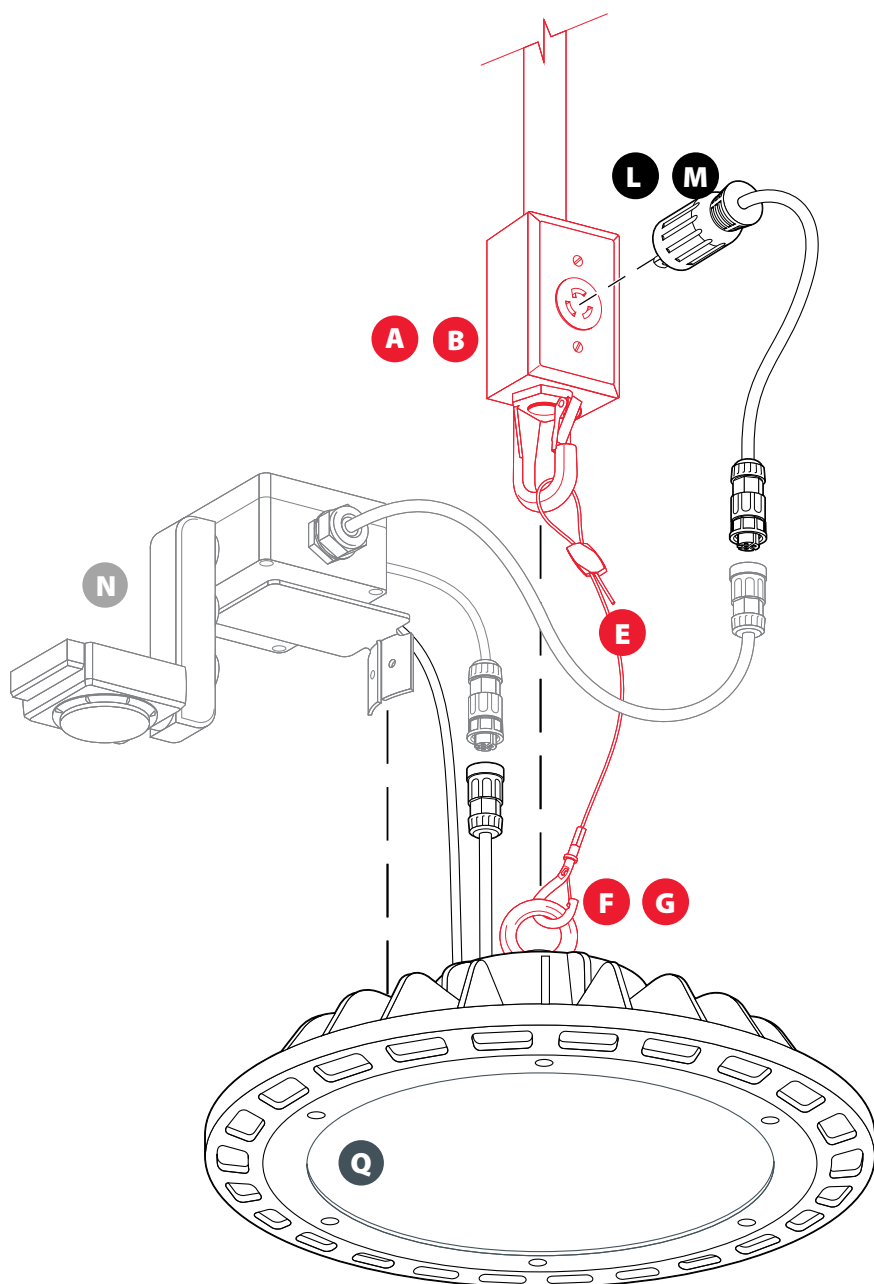

PART NUMBER MATRIX & COLOR GUIDE:

Product family	Wattage	Color	Lens	Color Temperature	Dimming	Coating
HB - LED High Bay	125 - 125W	B - Black	1 - Glass, Frosted	40 - 4000K	DL - 0-10V Dimming	T - Corrosion Resistant Powder Coat
	185 - 185W	W - White	2 - Polycarbonate, Frosted	50 - 5000K		
	220 - 220W		3 - Polycarbonate, Clear			
	125 - 125W		4 - Glass, Clear			

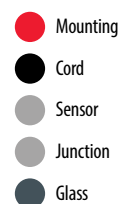

Note: Black color/clear glass is standard

MOUNTING ACCESSORIES¹

IMAGE	ORDERING CODE	DESCRIPTION	ACCESSORY USE
A	HBAM26	120V Socket Hub & Junction Box with 3/4" Snaphook	Connects to NEMA L5-15 plug. Cable can be passed through top of socket hub via hole in snaphook; used to connect High Bay cable to conduit — 3/4" threaded pipe
B	HBAM27	277V Socket Hub & Junction Box with 3/4" Snaphook	Connects to NEMA L7-15 plug. Cable can be passed through top of socket hub via hole in snaphook; used to connect High Bay cable to conduit — 3/4" threaded pipe
C	HBAM28	Pass thru Junction Box with 3/4" Snaphook	Opening at top and bottom allow for internal connecting of cable and provide mechanical fixturing support; top hole includes 3/4" threaded pipe
D	HBAM29	Snaphook with 3/4" Pipe Adapter	Connects directly to conduit via 3/4" threaded pipe, providing fixturing support
E	HBAM30	5' Safety Cable with Cable Lock and Snap Lock Hook	Five-foot aircraft safety cable with snap lock hook; adjustable cable lock on opposite end to allow end user to adjust length to installation needs
F	HBAM20	Round Hook 24x42x60 M10	The stainless steel round loop option is designed for use with the smaller 125 and 185 watt high bay fixtures
G	HBAM21	Round Hook 29x49x69 M12	The stainless steel round loop option is designed for use with the larger 220 watt high bay fixtures
H	HBAM22	9" x 9" Aluminum Swivel Yoke Bracket- Black	Color matched and sized to work with our standard black colored 125, 185 and 220 watt fixtures; it allows for positioning at five different angles — 0°, 45°, 90° and 180°, allowing for optimal mounting flexibility
I	HBAM23	9" x 9" Aluminum Swivel Yoke Bracket- White	Color matched and sized to work with our standard white colored 125, 185 and 220 watt fixtures; it allows for positioning at five different angles — 0°, 45°, 90° and 180°, allowing for optimal mounting flexibility

CORDS

IMAGE	ORDERING CODE	DESCRIPTION	ACCESSORY USE
J	HBAC05	15A 120-277V 3 Wires 10' Cord Waterproof Twist Connect- Black	Cord is 10' long. Length helps to install High Bay away from power source. 3 wires connected to junction box. Other end connects with Twist connect of High Bay
K	HBAC06	15A 120-277V 3 Wires 10' Cord Waterproof Twist Connect- White	Cord is 10' long. Length helps to install High Bay away from power source. 3 wires connected to junction box. Other end connects with Twist connect of High Bay
L	HBAC03	15A 277V L7-15P Plug 2' Black Cord Waterproof Twist Connect	This NEMA L7-15P Plug - twist connects with L7-15R receptacle. Other end easily connects with Twist connect of High Bay
M	HBAC01	15A 120V L5-15P Plug 2' Black Cord Waterproof Twist Connect	This NEMA L5-15P Plug - twist connects with L5-15R receptacle. Other end easily connects with Twist connect of High Bay

SENSORS & JUNCTION ACCESSORIES

IMAGE	ORDERING CODE	DESCRIPTION	ACCESSORY USE
N	HBAS40	IP 20 PIR Motion Sensor with Junction Box	WattStopper HBP-112 High Bay Passive Infrared (PIR) Occupancy Sensors provide control of individual High Bay LED in indoor high and low bay spaces. Includes preconnected junction box
O	HBAS41	IP 65 PIR Motion Sensor with Junction Box	WattStopper HB340W-L3 and HB340W-L4 High Bay Passive Infrared (PIR) Occupancy Sensors for Wet Locations consist of a sensor and a lens module and preconnected junction box
P	HBAJ60	Junction Box with Bracket	Interim junction box for use with controls other than those available through Litetronics; junction box features an internal terminal block for easy wiring and two external cables

CLEAR & FROSTED GLASS 0-10V DIMMING SPECIFICATIONS²

IMAGE	VOLTS	WATTAGE	CCT (K)	CLEAR			FROSTED			DIMMING
				LUMENS	C.B.C.P	ORDERING CODE	LUMENS	C.B.C.P	ORDERING CODE	
Q	120 - 277	125	4000	16,000	5402	HB125B440DL	15,000	4753	HB125B150DL	0 - 10V
			5000	16,000	5402	HB125B450DL	15,000	4753	HB125B150DL	
		185	4000	24,000	7848	HB185B440DL	22,000	6906	HB185B140DL	
			5000	24,000	7848	HB185B450DL	22,000	6906	HB185B150DL	
		220	4000	29,000	9086	HB220B440DL	26,000	7995	HB220B140DL	
			5000	29,000	9086	HB220B450DL	26,000	7995	HB220B150DL	

¹ All accessories available in case quantities of 10

² Glass options for Black High Bay, White versions available upon request

³ Warranty— 1. for installations where ambient temperature exceeds 45C, warranty is reduced to 5 years.

2. Maximum operating temperature is 55C.

3. For higher temperature applications consult Litetronics.

MAKE THE SWITCH TO EASY, ENERGY-EFFICIENT LED HIGH BAY

Learn about our 60-day free trial or sign up for a free lighting layout at:
Litetronics.com

LITETRONICS®

Talk to your distributor or contact us at
CustomerService@Litetronics.com or 1-800-860-3392
6969 W. 73rd Street Bedford Park, IL 60638



We are a Family-Owned, U.S. Company

Since Litetronics' founding in 1970, our family-owned, U.S. company has been passionate about finding ways to make lighting easier to install, better looking, longer lasting and more efficient. We're proud of our reputation for world-class engineering and quality control.